

Pump Maintenance Instruction -

DMC: GENERIC-000-000-00-00-00AA-520A-A

Language: en/US

Issue no: 001

Issue Date: 2010-12-06

Title: Pump Maintenance Instruction -

Security classification : Class01

Responsible partner company:

Originator:

Applicability:

QA: Unverified

Intentionally left blank

Pump Maintenance Instruction -

Table of Contents	Page
Preliminary Requirements.....	1
Procedure.....	2
List of Figures	Page
1	3
2	4

Preliminary Requirements

Required Conditions

Table 1 Required Conditions

Title	Data Module
None	

Support Equipment

Table 2 Support Equipment

Nomenclature	Identification No.	Qty	Remarks
None			

Consumables, Materials, and Expendables

Table 3 Consumables, Materials, and Expendables

Nomenclature	Identification No.	Qty	Remarks
None			

Spares

Table 4 Spares

Nomenclature	Identification No.	Qty	Remarks
None			

Safety Conditions

None

Procedure

Remove the Pump Valve Housing using number 15 wrench Fig. 1

Remove the Pump Valve Housing and inspect the rotors for cracks and fouling. Fig. 2

Replace as appropriate using Maintenance Procedure JC0346.

Prior to re-installation of the Pump Valve Housing, ensure the gasket is resealed with the correct gasket sealant.

Reinstall the Pump Valve Housing.

Reinstall the Pump Valve.

Note

Ensure that all bolts are tightened to 25nm.

Loosen the pump adjuster by .5 turn.

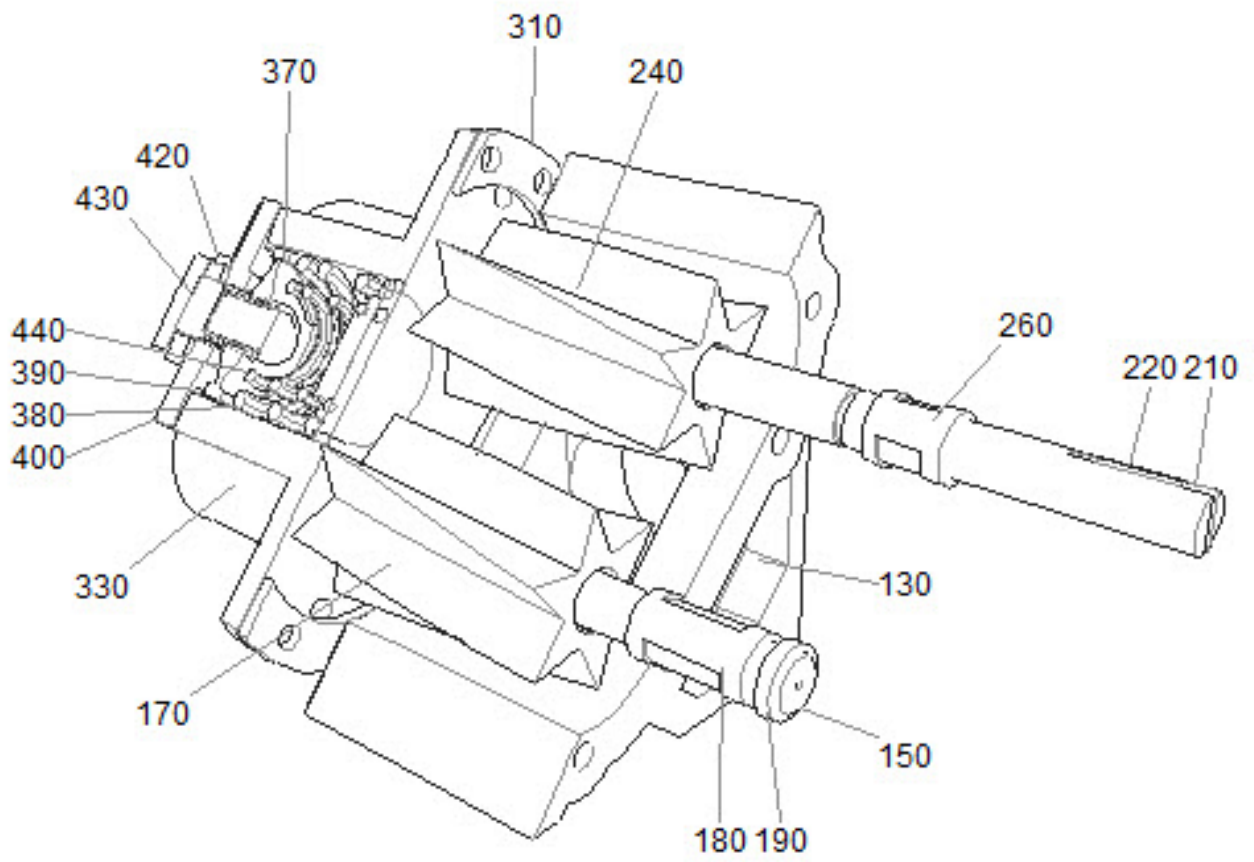

Figure 1



Figure 2

Multimedia Object reference here

Required Conditions

Table 5 Required Conditions

Title	Data Module
None	

Intentionally left blank